

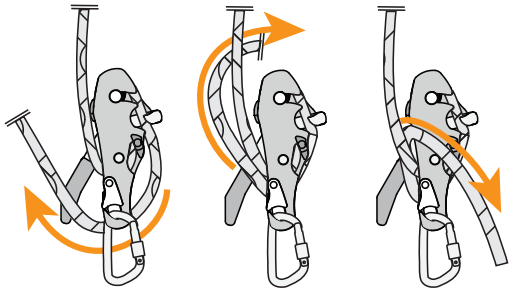

Technical Information Note Using the Prism & Quantum

Locking off the Prism

Soft lock - permissible for short periods while fully suspended



Full lock - "double soft lock"

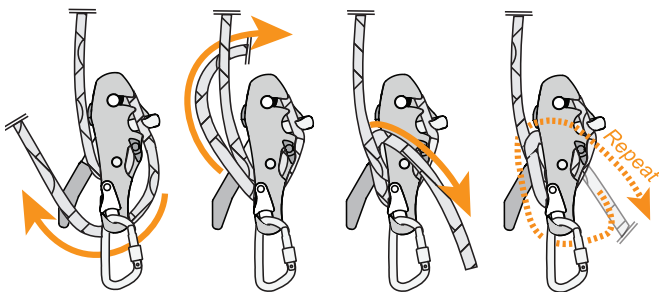

Full lock

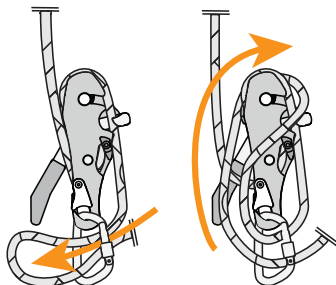

Check connector gate is fully done up

Variable Friction Modes

Normal friction

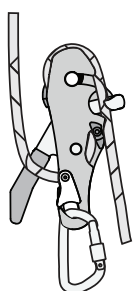

Variable reduced Friction

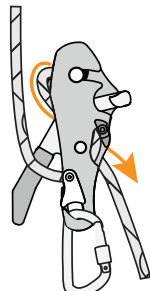

Paying in/out

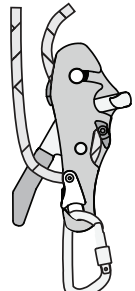

The Prism in Use

Controlling descent speed

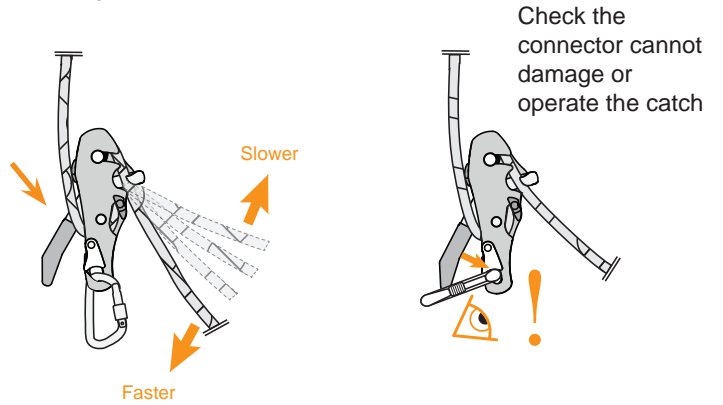

Always hold the tail rope

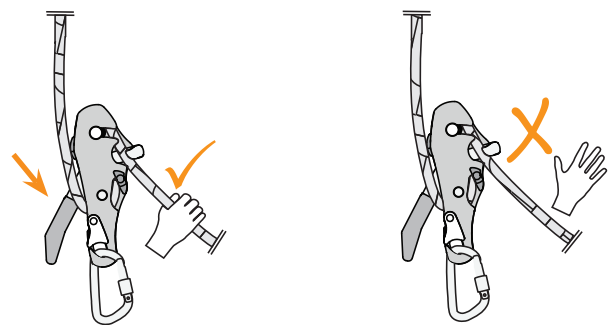

Do not allow slack to develop in working line

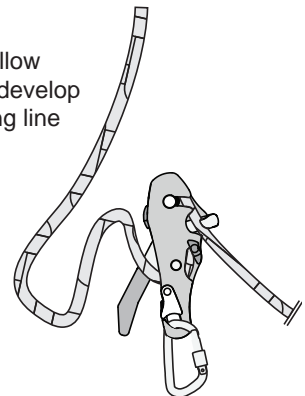

Key to symbols



Correct practice



Incorrect practice



Take extra care

Technical Information Note Using the Prism and Quantum

Attaching the Quantum

Lanyard (cowstail) length

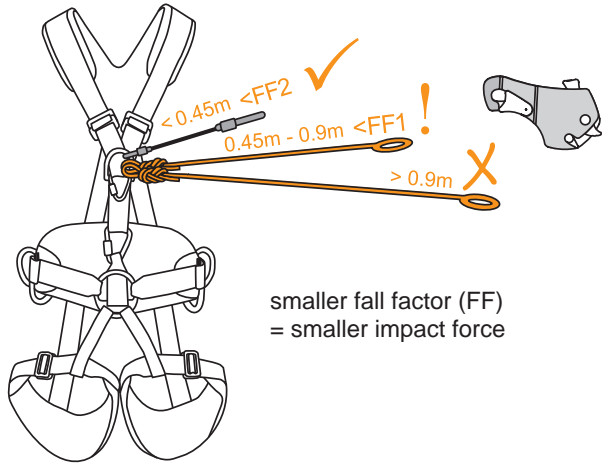

smaller fall factor (FF)
= smaller impact force

Ensure connector is free to move

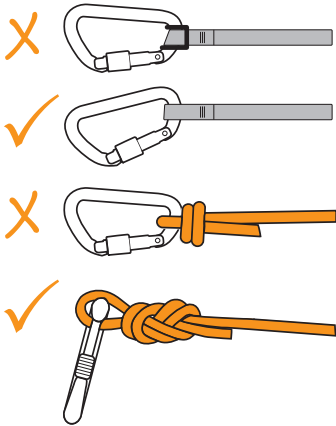

Check the connector cannot damage
or operate the catch

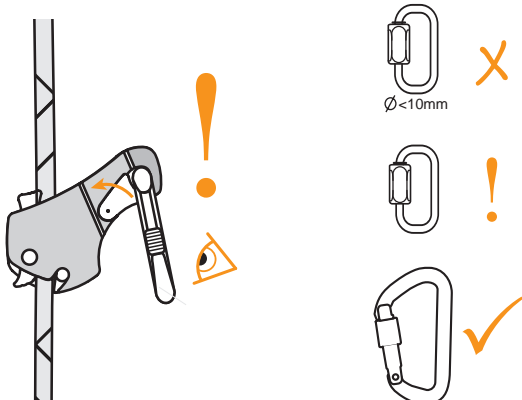

The Quantum in Use

Rope size

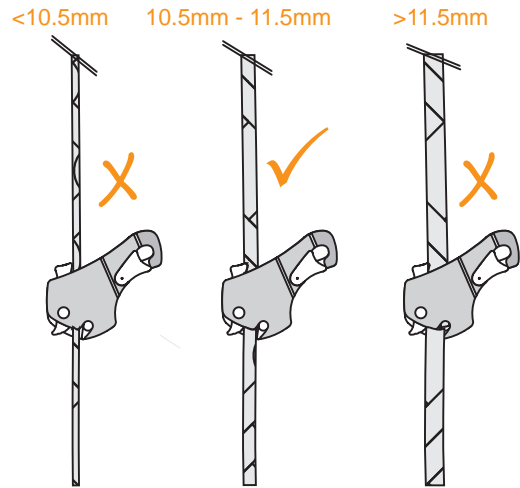

To assist parking on a loaded rope, add karabiners.
Quantum can still be moved by lanyard

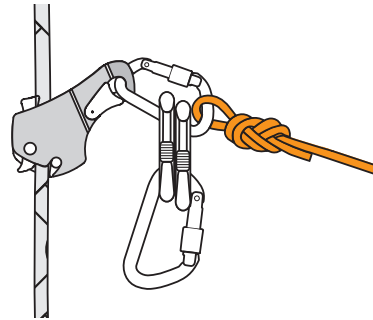

Do not allow slack to develop in back-up line

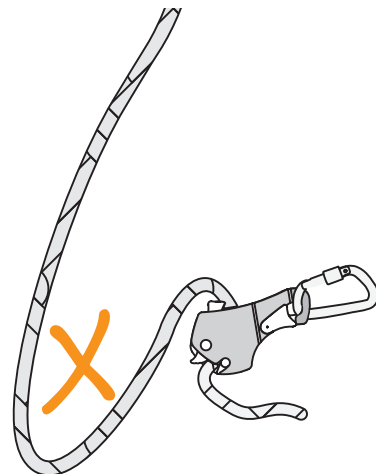

Descending Down a Slope

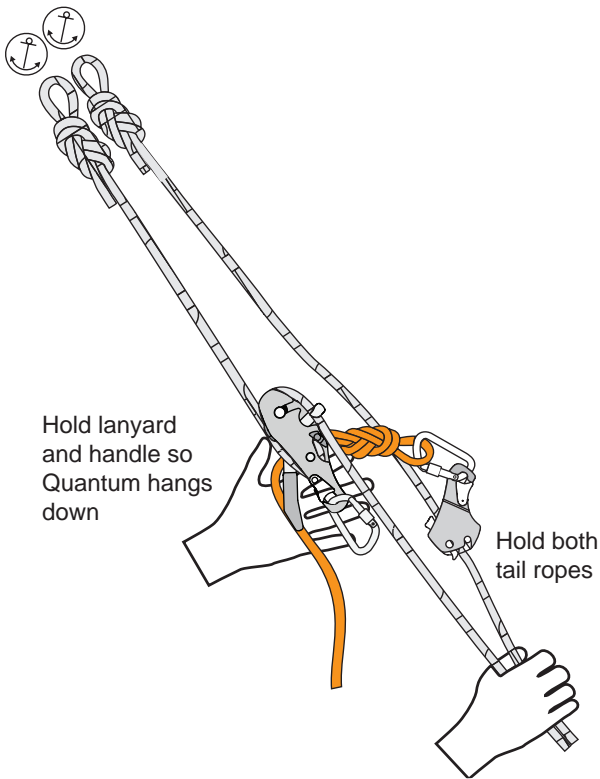

Hauling/Rescue System

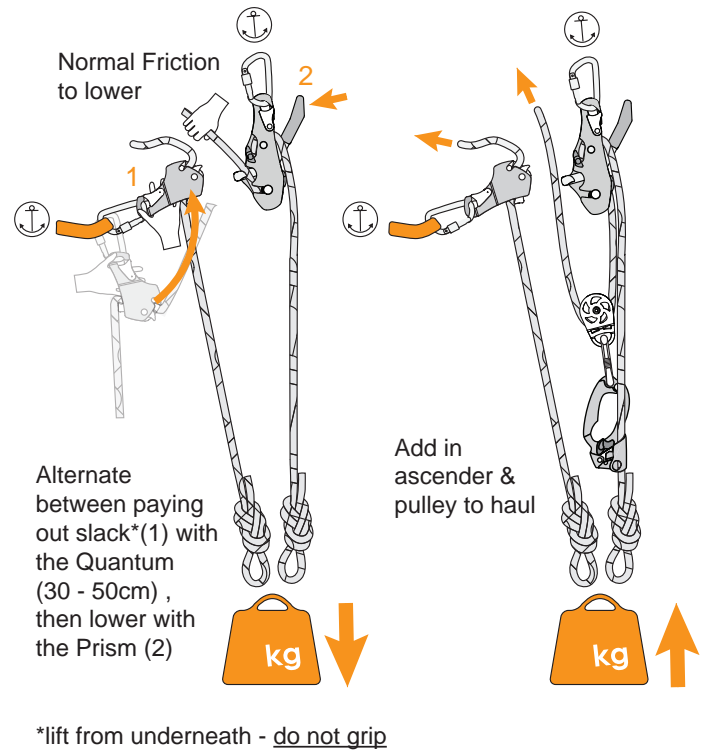

Rescue from Casualty's Ropes

On tensioned ropes slippage and impact forces will be higher - keep device as high as possible.

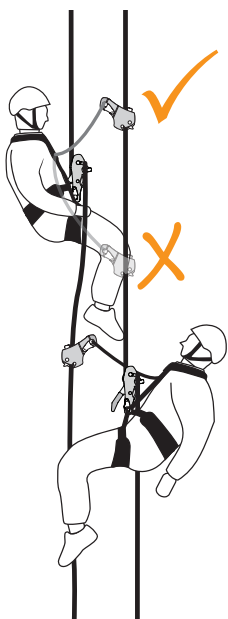

If ascending to the casualty, be aware that the casualty's fall distance will be higher - especially if their Quantum is in fall factor 2

Rigging for Rescue

Prism must be fully locked off when not lowering

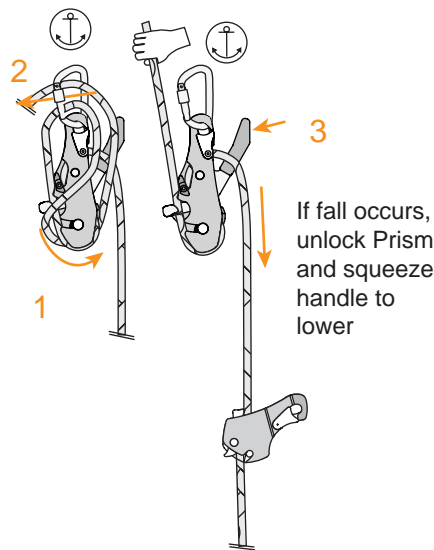

Tensioned Line

